

Accumulator Shells

Bottom Repairable

ASME/CE

Bladder Accumulator Spun Shells



| Size | Part No. | DIA "A" | DIA "B" | DIA "C" | LENGTH "L" |
|---------|----------|---------|---------|---------|------------|
| 1 Gal | 3251029 | 0.875 | 2.750 | 6.00 | 10.80 |
| 2.5 Gal | 3251030 | 0.875 | 3.500 | 8.00 | 15.50 |
| 5 Gal | 3251031 | 0.875 | 3.500 | 8.00 | 27.50 |
| 10 Gal | 3251032 | 0.875 | 3.500 | 8.00 | 48.25 |
| 11 Gal | 3251033 | 0.875 | 3.500 | 8.00 | 54.13 |
| 15 Gal | 3251034 | 0.875 | 3.500 | 8.00 | 72.00 |

- Cr-Mo Steel Spun Shells
- ASME Coded and U-Stamped
- CE Certified and Stamped for Module G
- National Board Registered
- ASME Rated @ 3000 PSI
- CE Rated @ 207 Bar
- Appendix 22 available upon request
- Zinc Phosphate Coated
- Also available in Top Repairable
- Special Sizes available upon request

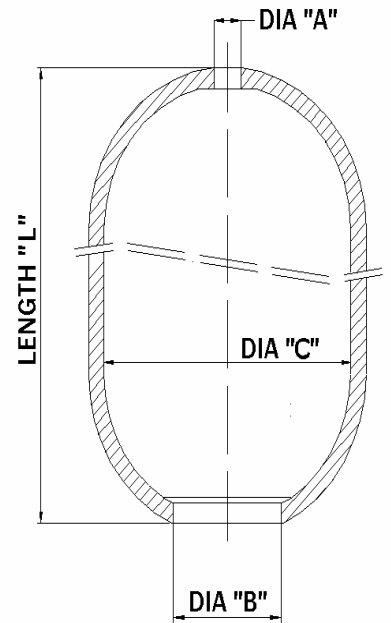

FLUID ENERGY CONTROLS, INC.

6431 FLOTILLA STREET
LOS ANGELES, CA 90040 USA
TEL:(323) 721-0588
FAX:(323) 721-8368
E-MAIL: sales@fecintl.com